



Wardour Street, Soho, W1F 8WN
£865 pw

› 3 Bedrooms › 2 Bathroom › Unfurnished

TAVISTOCKBOW
RESIDENTIAL



- › Three bedrooms
- › Two bathrooms
- › 1st/2nd/3rd Floors
- › Open plan kitchen
- › Carpets throughout
- › Unfurnished
- › Listed building
- › Contemporary finish
- › Available mid April
- › Close to Leicester Square tube & Tottenham Court Road

› A beautiful three-bedroom, two-bathroom maisonette on wonderful Wardour Street. Arranged over the 1st, 2nd & 3rd floors of a stunning period building, the property retains many original features such as fireplaces and panelling but has a fantastic contemporary feel.

Available from mid-April on an unfurnished basis.





WHAT WE LOVE:

- A stunning listed building
- Your very own front door
- Some amazing restaurants on your doorstep
- The beautiful master bathroom
- The original fireplaces.

WHAT YOU NEED TO KNOW:

- Arranged over three floors
- Three double bedrooms
- Carpet throughout
- Induction cooking
- Westminster Council.

Floorplan

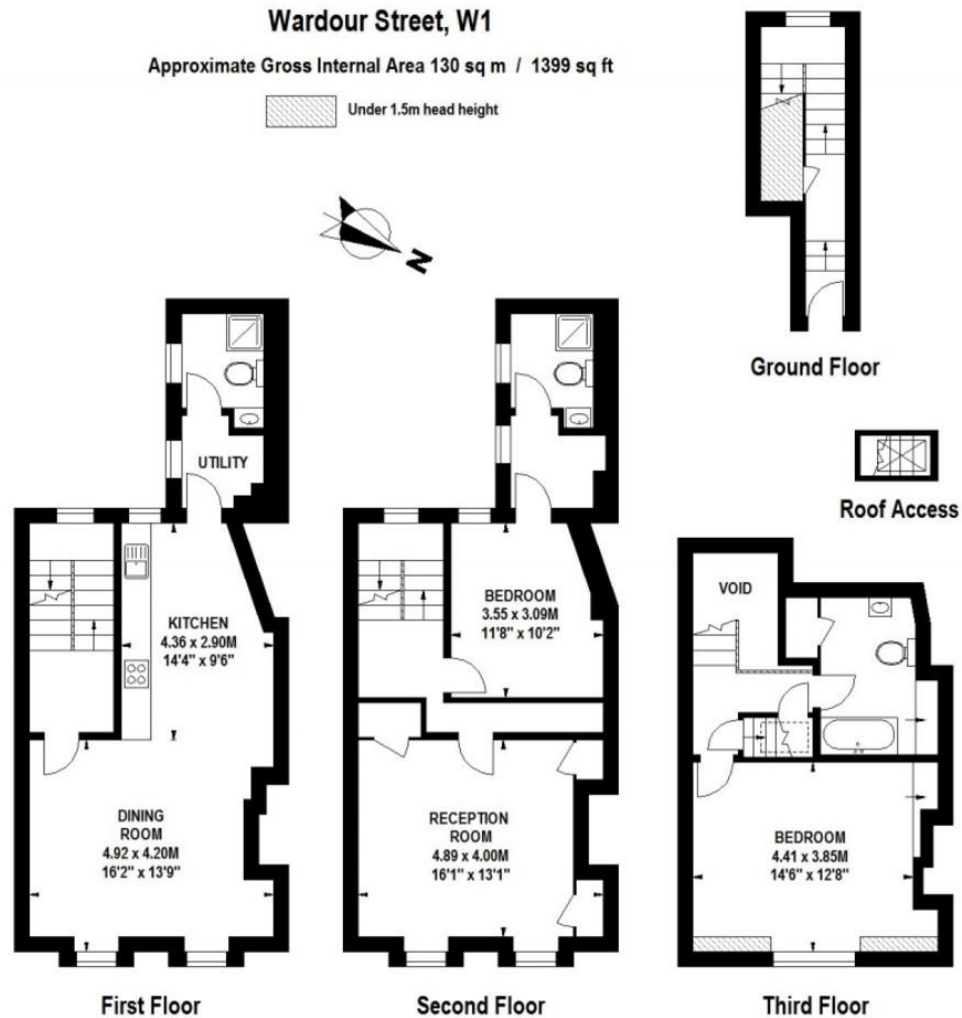

Floor Plan produced for Tavistock Bow by Mays Floorplans ©. Tel 020 3397 4594
 Illustration for identification purposes only, not to scale
 All measurements are maximum, and include wardrobes and window bays where applicable

EPC

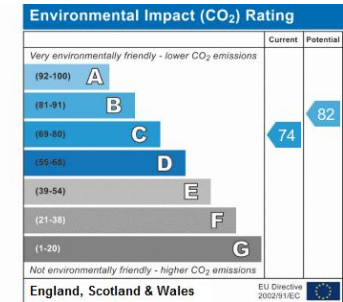
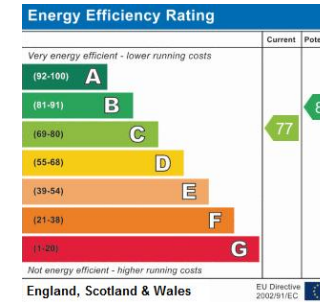



About Us

Tavistock Bow is an independent residential agency based in Covent Garden. We are niche, boutique, creative, knowledgeable, professional and approachable. We love what we do and that's why we do it.

Contact Us

- a.** 31 Long Acre, London, WC2E 9LA
- t.** 020 7477 2177
- e.** hello@tavistockbow.com
- w.** tavistockbow.com

-  /tavistockbow
-  /tavistockbow
-  @tavistockbow



TAVISTOCKBOW
 RESIDENTIAL