



Fielding Court, Earlham Street, Covent Garden, WC2H 9LN
£525 pw

› 1 Bedroom › 1 Bathroom › Furnished

TAVISTOCKBOW
RESIDENTIAL



- › One double bedroom
- › One bathroom
- › 2nd floor
- › Recently refurbished
- › Lift access
- › Furnished
- › Available early May
- › Quiet position within the building
- › Wood floors
- › Close to Leicester Square & Covent Garden station

› A recently refurbished one bedroom apartment on the 2nd floor (lift) of this popular development in Seven Dials. Fielding Court is ideally located on the Seven Dials roundabout close to all the shops and restaurants that the area has to offer. The apartment has a good size reception room with wood floors, separate kitchen including a dishwasher and washing machine, double bedroom with good storage and a modern bathroom. The apartment is available early May on a furnished basis.





WHAT WE LOVE:

Newly refurbished
Great location in Sevensdials
Good light
Wood floors
Seconds from some great restaurants and shops.

WHAT YOU NEED TO KNOW:

2nd floor
Lift access
Located towards rear of the building
Close to Leicester Square & Covent Garden tube
Available early May.



Fielding Court, WC2H

Approximate gross internal area
42 sq m / 452 sq ft

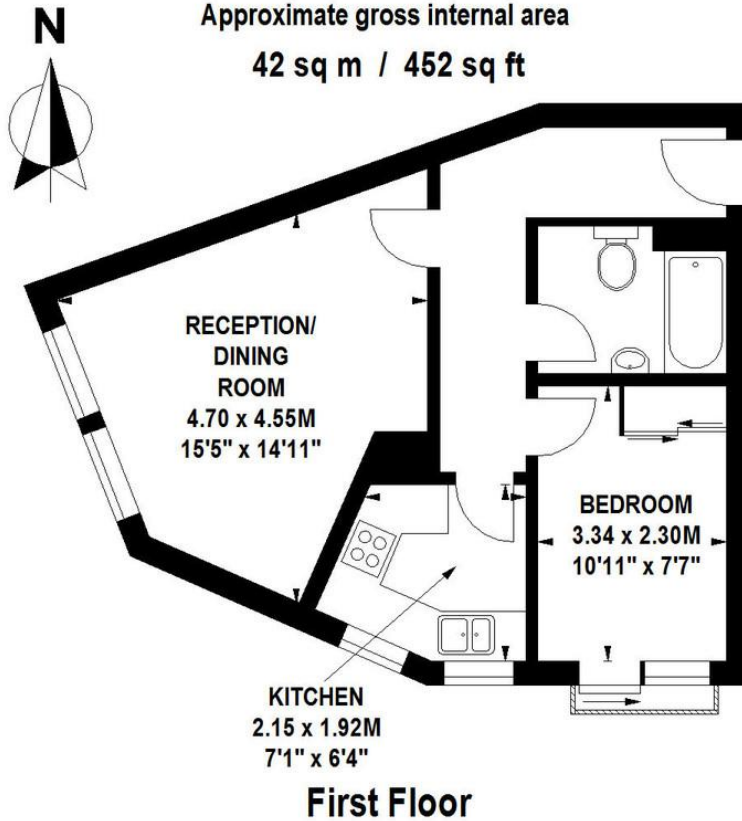

Floor Plan produced for Tavistock Bow by Mays Floorplans © . Tel 020 3397 4594
Illustration for identification purposes only, not to scale
All measurements are maximum, and include wardrobes and window bays where applicable

EPC

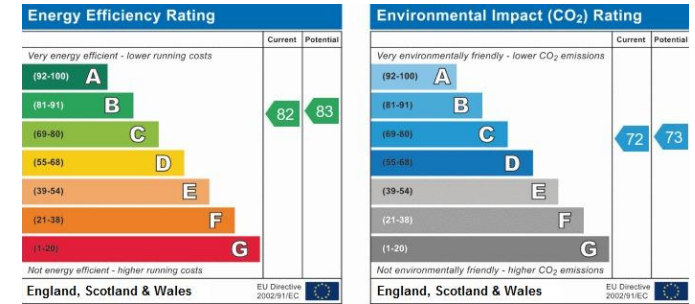

About Us

Tavistock Bow is an independent residential agency based in Covent Garden. We are niche, boutique, creative, knowledgeable, professional and approachable. We love what we do and that's why we do it.

Contact Us

- a.** 8 Tavistock Street, London WC2E 7PP
- t.** 020 7477 2177
- e.** hello@tavistockbow.com
- w.** tavistockbow.com

