



Rupert Street, Chinatown, Soho, W1D 6DN  
**£375 pw**

› Studio    › 1 Bathroom    › Unfurnished

**TAVISTOCKBOW**  
RESIDENTIAL



- › Studio apartment
- › Shower room
- › 4th floor (top)
- › Good storage
- › Wooden flooring
- › Unfurnished
- › Walk up
- › Secondary glazing
- › Available immediately
- › Close to Piccadilly circus tube



An amazing top floor (4th floor) studio flat. The flat features an open plan living space with the sleeping area tucked into a corner. There is great storage and a good sized shower room with further storage. Available immediately, on an unfurnished basis.







**WHAT WE LOVE:**

- Recently refurbished
- Good specification
- Great natural light
- Close to amazing restaurants
- Separate sleeping area (open plan).

**WHAT YOU NEED TO KNOW:**

- Dishwasher
- Washer/dryer
- Electric heating
- 4th floor (walk up)
- Westminster council tax.



# Floorplan

## Rupert Street, W1

Approximate Gross Internal Area 30 sq m / 323 sq ft

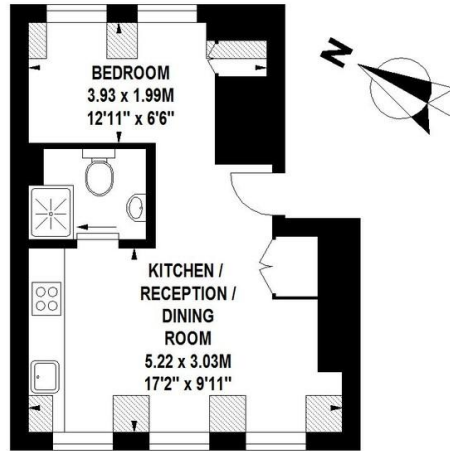

**Fourth Floor**

Floor Plan produced for Tavistock Bow by Mays Floorplans © . Tel 020 3397 4594  
 Illustration for identification purposes only, not to scale  
 All measurements are maximum, and include wardrobes and window bays where applicable

# EPC

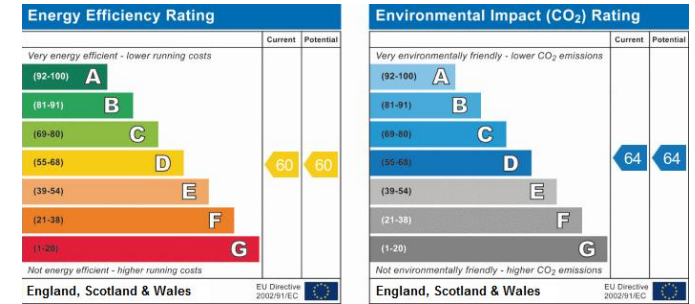

## About Us

Tavistock Bow is an independent residential agency based in Covent Garden. We are niche, boutique, creative, knowledgeable, professional and approachable. We love what we do and that's why we do it.

## Contact Us

- a.** 31 Long Acre, London, WC2E 9LA
- t.** 020 7477 2177
- e.** hello@tavistockbow.com
- w.** tavistockbow.com

-  /tavistockbow
-  /tavistockbow
-  @tavistockbow