



WINTER GARDEN HOUSE, MACKLIN STREET WC2
£655,000 LEASEHOLD (DRAFT PARTICULARS, AWAITING APPROVAL)

> 1 Bedroom > 1 Bathroom

TAVISTOCKBOW
RESIDENTIAL



- One Bedroom
- 7th Floor
- Passenger Lift
- Corner Position
- Dual Aspect
- Far Reaching Views
- 514 Sq. Ft. (Approx.)
- Close to Crossrail
- Moments from Theatreland
- Central yet Quiet Location



A bright and well presented one bedroom flat on the seventh floor (with lift) of this centrally located, purpose built block with far reaching views over London's West End taking in landmarks including The Royal Opera House, Centre Point, Nelson's Column, The Savoy, London Eye and even Battersea

Power Station. Macklin Street is situated just off Drury Lane, moments from the heart of London's Theatreland. Central Covent Garden and its many attractions is only a few moments walk and the bustling nightlife of Soho is within easy reach. The major Crossrail interchange at Tottenham Court

Road is literally around the corner and both Holborn & Covent Garden Tube Stations are nearby.





WHAT WE LOVE

- The amazing views over the West End
- Loads of great natural light
- A feeling of being on top of the world
- The awesome Sun pub just across the road
- Great proximity to Crossrail

WHAT YOU NEED TO KNOW

- Seventh Floor
- Lift
- Double Glazing
- Leasehold - 74 years approx.
- Service Charge - £1488.43 PA (2018/19)

Floorplan

Winter Garden House, WC2
 Approx. Gross Internal Area
 514 Sq Ft - 47.75 Sq M

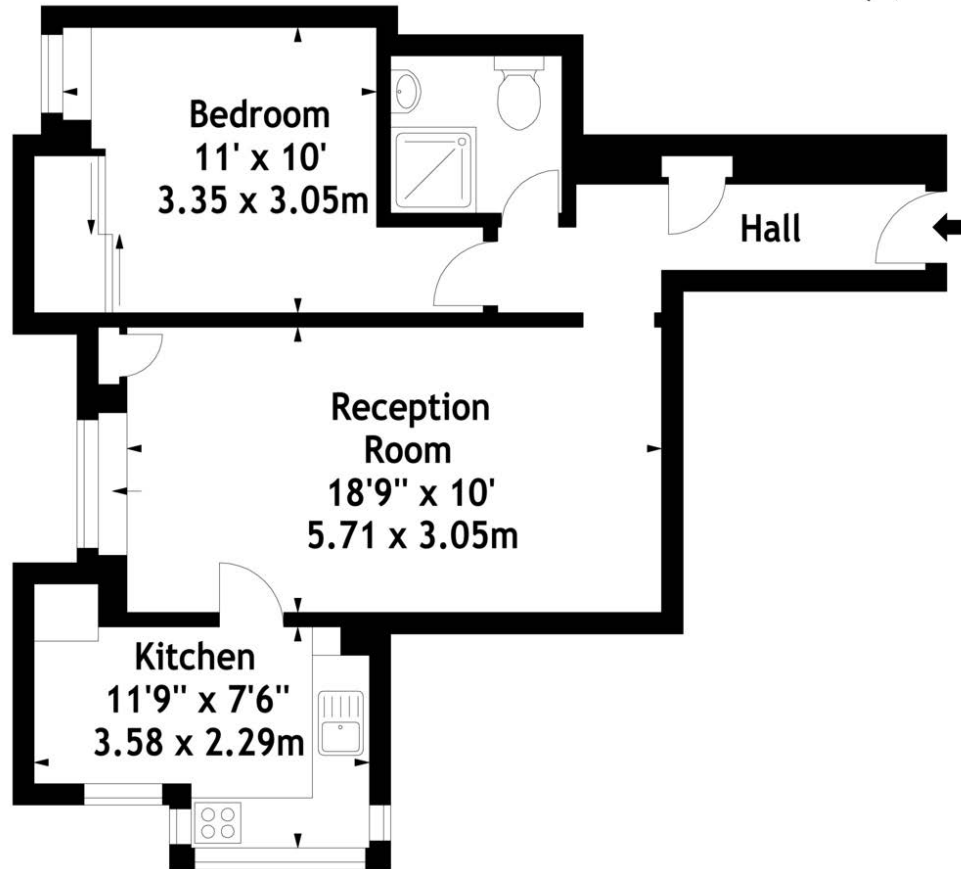
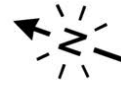

Seventh Floor

EPC

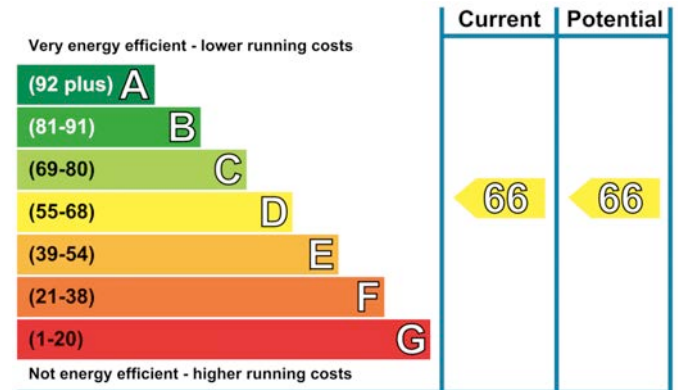

About Us

Tavistock Bow is an independent residential agency based in Covent Garden. We are niche, boutique, creative, knowledgeable, professional and approachable. We love what we do and that's why we do it.

Contact Us

- a. 31 Long Acre, London, WC2E 9LA
- t. 020 7477 2177
- e. hello@tavistockbow.com
- w. tavistockbow.com

- f /tavistockbow
- ig /tavistockbow
- tw @tavistockbow