



Wellington Street, Covent Garden, WC2E 7BD  
*£450 pw*

› Studio    › 1 Bathroom    › Unfurnished

**TAVISTOCKBOW**  
RESIDENTIAL



- › Studio
- › One bathroom
- › Open plan kitchen
- › Wood floors
- › Good ceiling height
- › Unfurnished
- › Third floor (walk up)
- › Good size (409 sq ft)
- › Available immediately
- › Close to Charing Cross & Covent Garden tube

› Wellington Street is in a fantastic location just off Covent Garden's Piazza and this studio apartment is situated on the third floor of an attractive period building, with pitched ceilings and wood floors throughout this studio is a great size at just over 400 sq ft, there is a modern open plan kitchen and bathroom. Available immediately on an unfurnished basis.

Wellington Street is in a fantastic location just off Covent Garden's Piazza and this studio apartment is situated on the third floor of an attractive period building, with pitched ceilings and wood floors throughout this studio is a great size at just over 400 sq ft, there is a modern open





### WHAT WE LOVE:

- Great location in the Opera Quarter of Covent Garden
- Superb size for a studio
- Seconds from the beautiful Royal Opera House
- Great Korean food at On the Bab a few doors away
- A short walk from Waterloo bridge - our favourite London view.

### WHAT YOU NEED TO KNOW:

- Third floor (walk up)
- Above Cafe Rouge
- Open plan living space
- Wood floors throughout
- Photos and floor plan are indicative of another flat in the building.



## Wellington Street, Covent Garden, WC2

Approximate Gross Internal Area 38 sq m / 409 sq ft

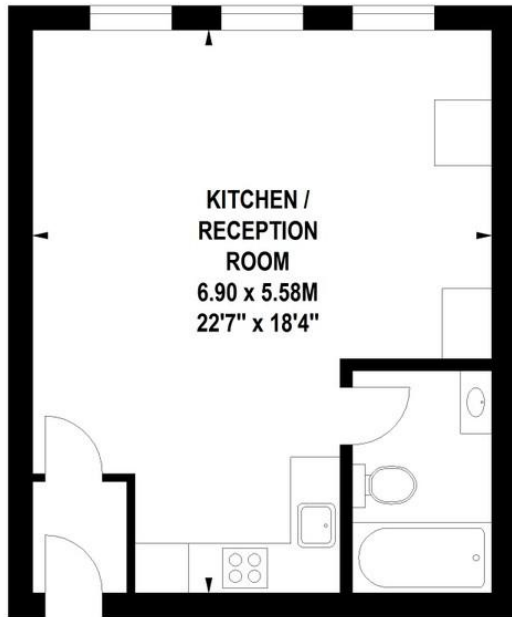

**First Floor**

Floor Plan produced for Tavistock Bow by Mays Floorplans © . Tel 020 3397 4594  
 Illustration for identification purposes only, not to scale  
 All measurements are maximum, and include wardrobes and window bays where applicable

## EPC

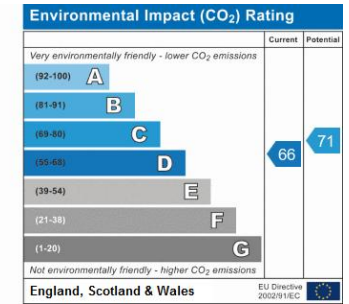
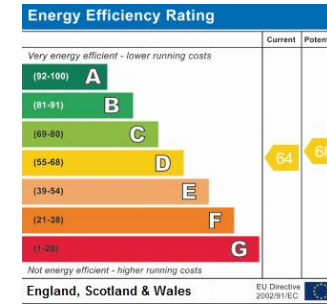

## About Us

Tavistock Bow is an independent residential agency based in Covent Garden. We are niche, boutique, creative, knowledgeable, professional and approachable. We love what we do and that's why we do it.

## Contact Us

- a.** 31 Long Acre, London, WC2E 9LA
- t.** 020 7477 2177
- e.** hello@tavistockbow.com
- w.** tavistockbow.com

-  /tavistockbow
-  /tavistockbow
-  @tavistockbow



**TAVISTOCKBOW**  
RESIDENTIAL